



Christian Academy®
SCHOOL SYSTEM

CARPOOL

PRINTABLE NOTES AND MAPS

See the following pages for updated printable notes and maps.

ARRIVAL

For **arrival**, there is now only one route.

DISMISSAL

For **dismissal**, there are three routes:

*Choose the **one** that applies to your family.*

1. If you have only elementary students.
2. If you have elementary + middle/high school students.
3. If you have middle and/or high school students.

Recommended Arrival Times: Morning and Afternoon		
	Morning	Afternoon
Drivers with Elementary Students	7:15-7:40	2:45
Drivers without Elementary Students	7:15-8:00	3:15

ABOVE ALL ELSE: MAKE IT SAFE

CARPOOL EQUATION

1878 Students
1210 Families
340 Employees
1400 Vehicles
5 School Buses
+ Under One Hour

0%

Zero Room for Error

To help make things safer and faster, we ask these things:

1. Please do not drop off/pick up students in unapproved areas, such as the visitor parking lot, front of school, or adjoining neighborhoods. As these practices create safety risks, the school will follow a zero tolerance policy for offenders. For *repeat* offenders, the school will issue monetary fines and disciplinary consequences.
2. Please do not cut through an adjoining neighborhood unless you live there or are picking up someone who lives there. We want to be good neighbors.
3. When exiting from the main exit, please do not turn left from 7:15 to 8:15 and from 2:30 to 3:30, when traffic cones indicate a right turn, or when carlines exist. Turning left creates the potential for a serious accident, and it slows the line for everyone.

ARRIVAL (Updated 08/10/2022)

All carpool drivers should follow the **red** line around the athletic fields and school building. Drop off all students where indicated on the elementary side.

Please do not drop off students anywhere other than the yellow highlighted area on the elementary side.



By staging cars around the athletic fields and school building, we take up to 220 cars off the public roads, which makes us safer and helps our neighbors.

PLEASE DO NOT:

- Drop off students in unapproved areas, such as the visitor parking lot.
- Drop off students on public roads/neighborhoods and have them walk to school.
- Drive on the wrong side of the road, especially coming up the main entrance.

For drivers who repeatedly violate these safety requests, the school will consider appropriate consequences including the potential for monetary fines and student disciplinary measures.

DISMISSAL: IF YOU HAVE ONLY ELEMENTARY STUDENT(S)

Follow the **red** line around the athletic fields and school building. Pick up where indicated on the elementary side (same pick-up location for elementary as last year).

Please display your school-issued carpool number clearly in the window (not flat on the dash).

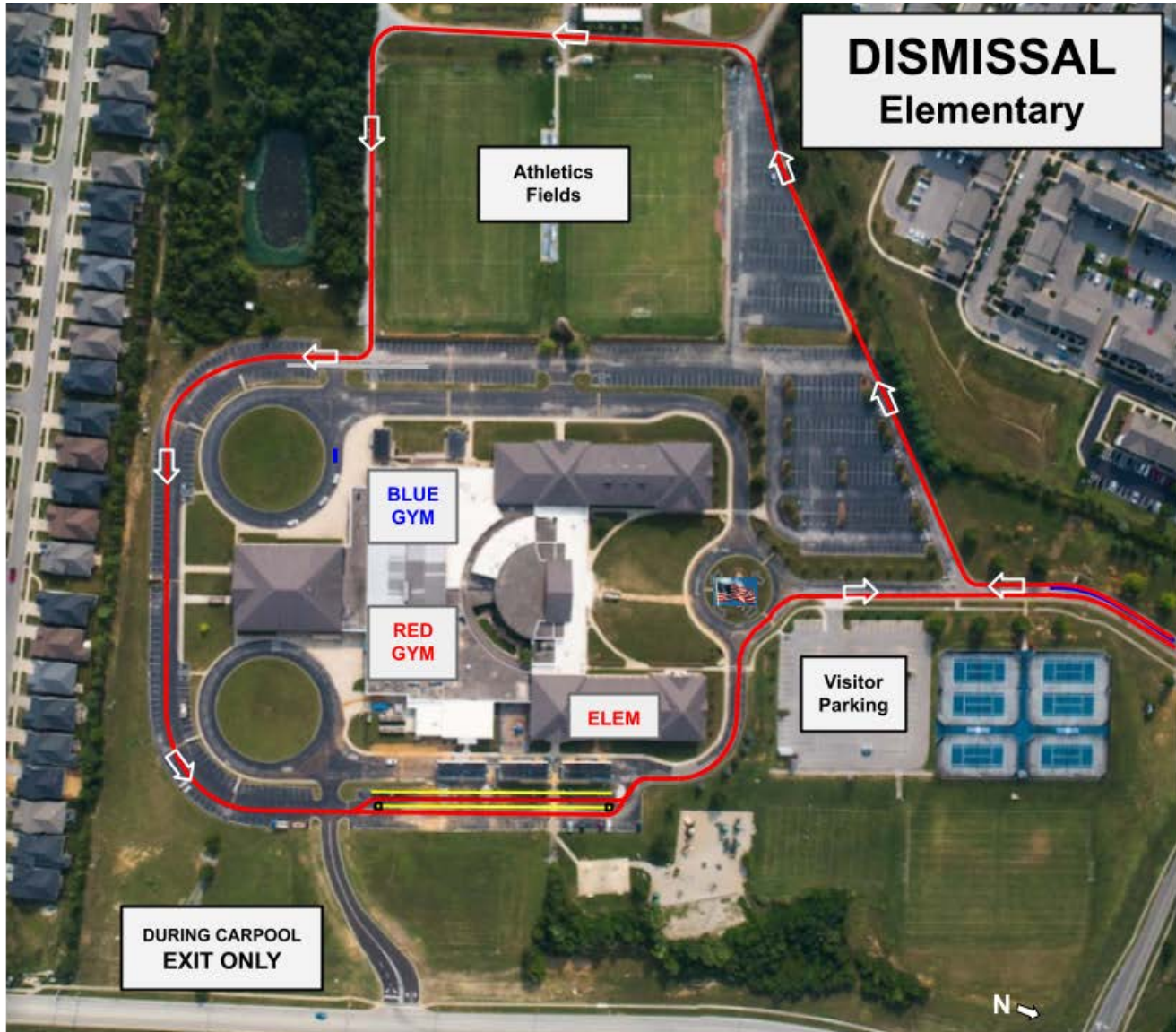

PLEASE DO NOT:

- Pick up students in unapproved areas, such as the visitor parking lot.
- Pick up students on public roads or in adjoining neighborhoods.
- Drive on the wrong side of the road, especially coming up the main entrance.

For drivers who repeatedly violate these safety requests, the school will consider appropriate consequences including the potential for monetary fines and student disciplinary measures.

DISMISSAL: IF YOU HAVE ELEM + MIDDLE/HIGH STUDENTS

Follow the **red** line around the athletic fields. Then split off into the gray (inside) line. Pick up your elementary and middle/high student(s) together in the **red** gym circle.

Please display your school-issued carpool number clearly in the window (not flat on the dash).

Please encourage your older children to help your younger children as appropriate.

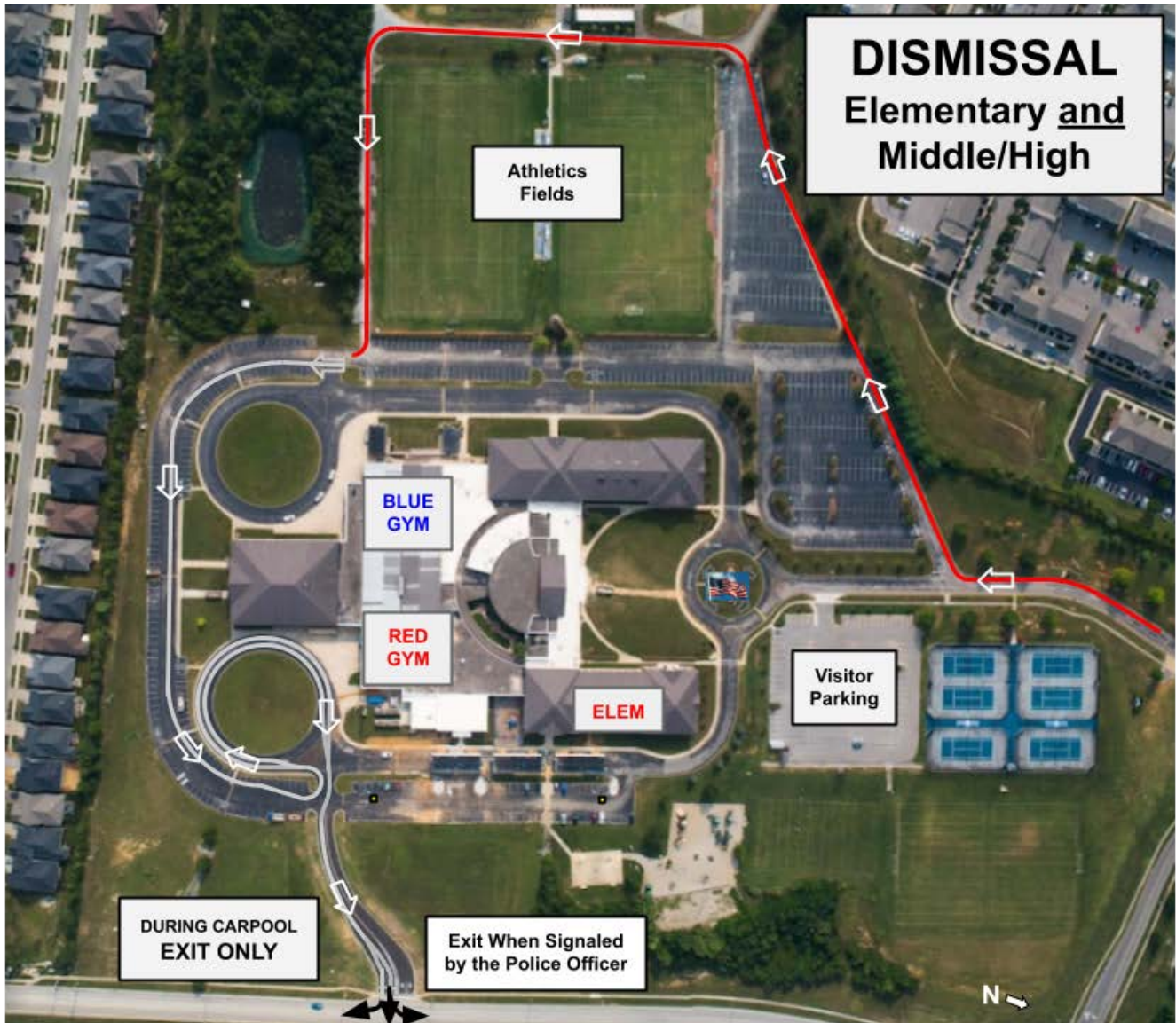

PLEASE DO NOT:

- Pick up students in unapproved areas, especially the visitor parking lot.
- Pick up students on public roads or in adjoining neighborhoods.
- Drive on the wrong side of the road, especially coming up the main entrance.

For drivers who repeatedly violate these safety requests, the school will consider appropriate consequences including the potential for monetary fines and student disciplinary measures.

Thank you to our drivers who show kindness to our carpool team, including our police officers (most of whom are CAL parents, too). Our team works outside regardless of weather conditions (Ephesians 4:32).



Thank you for choosing to send your child(ren) to CAL.
We sincerely value your continued confidence and trust.

P.S. Just for fun, see also: [You're Doing it Wrong](#) (One Minute Video)